

# RELAY MODULE - Battery or mains power version

## 99.746

MADE  
IN  
ITALY

## INSTALLATION/USE INSTRUCTIONS



All connections MUST be made with the electrical supply switched off and the batteries disconnected.

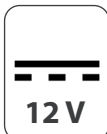
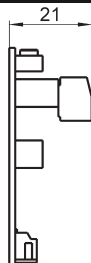
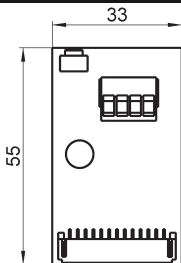
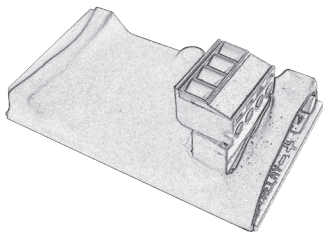

### GENERAL WARNINGS

*This manual is intended for technically qualified and trained installers.*

Mottura Serrature di Sicurezza S.p.A. thanks you for choosing this product and reminds you:

- Read the instructions very carefully before installing or doing any maintenance on the device.
- All assembly and connection procedures must be done according to Rules of Good Engineering as well as in conformity to law.
- DO NOT install this device in explosive environments or atmospheres or in the presence of flammable fumes/gases.
- DO NOT install this device on a door with risk of contact with water or atmospheric agents unless the door is adequately protected.
- Always disconnect the power supply and isolate all live parts before installing or doing any maintenance on the device. Take all possible precautions to eliminate the risk of electrical shock when doing the installation and/or maintenance procedures described in this manual.
- The installer must give these instructions and all maintenance instructions to the user.
- Keep these instructions for future use and attach the sales receipt to validate the warranty.
- In case of problems, contact your authorized dealer only.

Mottura Serrature di Sicurezza S.p.A. may change the characteristics of the products described in these instructions at any time and without notice.

### WARRANTY TERMS

This device has been inspected by Mottura Serrature di Sicurezza S.p.A. and is guaranteed against all manufacturing defects for the period defined by Italian law; the period begins on the date of purchase as demonstrated by the sales receipt. The warranty is effective if the sales receipt, bearing information identifying the device, is shown to the dealer or service personnel. The warranty covers the replacement or repair of parts found defective due to faulty manufacture; shipping costs to and from service centers are charged to the customer.

In case of a repeated malfunction of the same origin or a malfunction that cannot be repaired, Mottura Serrature di Sicurezza S.p.A. may decide, in its final judgment, to replace the entire device. The warranty on the replacement device will continue to the expiration of the original device. If the device must be serviced at the customer's home, the customer is required to pay (if requested) a minimum charge to cover the transfer costs of authorized service personnel.

Transport is at the customer's risk if the customer ships the device, and at the service personnel's risk if the device is picked up and transported by service personnel.

### LIMITS OF LIABILITY

The warranty does not cover damage deriving from:

- negligence, carelessness, or use other than as described below
- failure to protect the device before doing any procedure that may generate scrap or waste (welding, drilling of panels, drilling of structure, etc.) that prevents its correct functioning
- maintenance work not conforming to these instructions or done by unauthorized personnel
- use of accessories/components that are not original Mottura products
- shipping of the device without the necessary precautions
- any circumstances not attributable to manufacturing defects.

Operating temperature: -10°C to +55°C. In addition, Mottura Serrature di Sicurezza S.p.A. declines all liability for any harm to persons or damage to property deriving from failure to comply with all of the instructions and warnings contained in this manual.



ATTENTION: before powering and using this product, it is mandatory to read these notes, the instructions for use and any other document supplied, both in paper and electronic format, including by means of links of any kind. This product is intended for the exclusive use for which it was designed, built and sold; any other use other than that indicated as "compliant use" is not compliant and therefore not admissible. The intended use for this product is:



### INTERFACE WITH RELAY FOR ELECTRONIC LOCK OPENING

Any other use not expressly provided for or described here and in the official documentation is to be considered non-compliant and potentially dangerous for people, animals, things and the environment. The user assumes all risks in case of use that does not comply with the description contained herein. Mottura S.p.A. is in no way responsible for any non-compliant and unforeseen uses for this product, which may cause problems or damage of any kind to people, animals, things and the environment.

## 1 - INTRODUCTION

Relay MODULE (99.746) to start up to an actuator previously stored access credentials. Access credentials can be a numeric code, a TAG RFID, or a fingerprint that can be inserted by means of a dedicated external device connected to the control unit. Relay module permits the use of a Mottura electronic device (fingerprint reader art. 99.729/730/748/776 or numeric keypad art. 99.686/736/749/775) on any electric, electronic or motorized locks, via cable art. 99.699 (not included).

**The system can operate with a keypad, with a TAG RFID reader or with a fingerprint, for security reasons it is mandatory to store at least one master TAG to enable relay operation. The consensus given by the relay lasts for 1 second. Battery power or main power 12Vdc with mains adaptor cod. 99.683 or similar.**

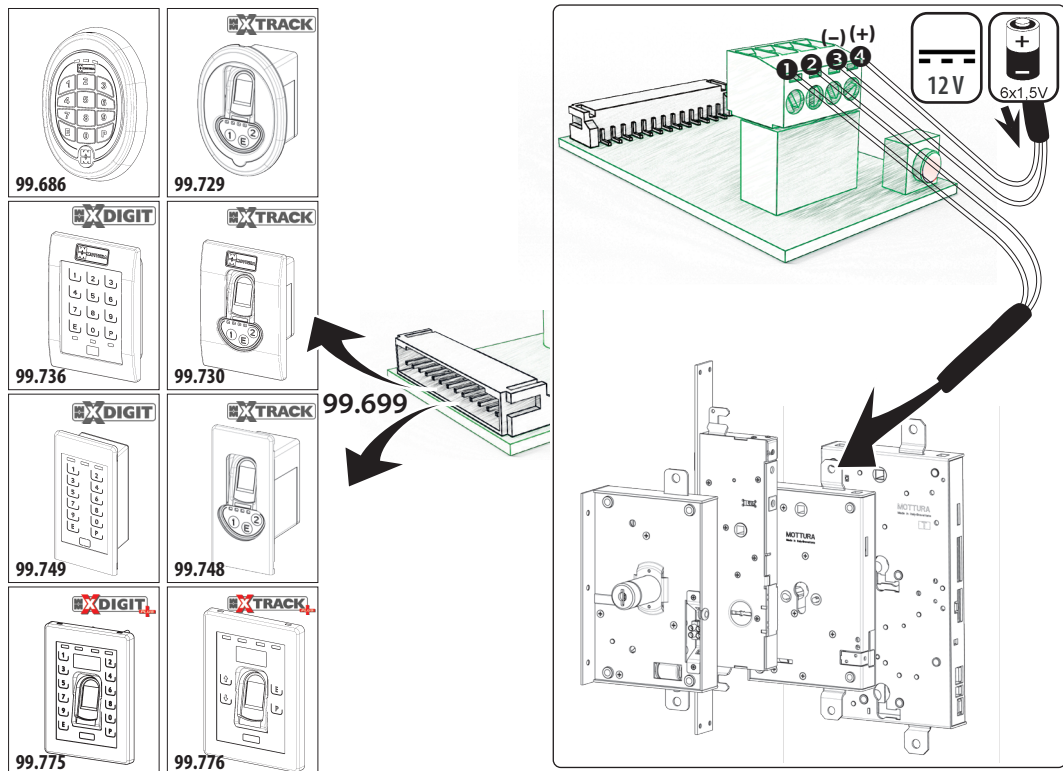

## 2 - SET-UP BUTTON FUNCTIONS

Relay MODULE is factory set up and does not require any changes. The following steps should only be performed only if needed to change the original setting. For example : replacing the keypad escutcheon with other device.

**WARNING :** Replacing the keypad escutcheon does not require authentication because the codes are stored in the control unit.

The set-up button allows following functions:

- fingerprint authentication
- reset of the control unit.

### 2.1 - FINGERPRINT ESCUTCHEON AUTHENTICATION

Fingerprint escutcheon must be authenticated with the control unit. For this operation, refer to the specific instructions.

### 2.2 - COMPLETE RESET OF THE CONTROL UNIT

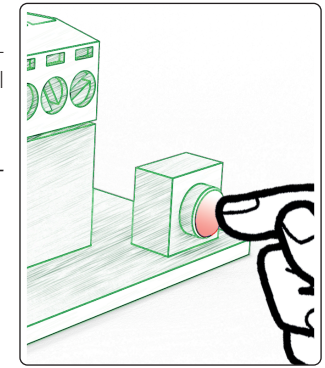
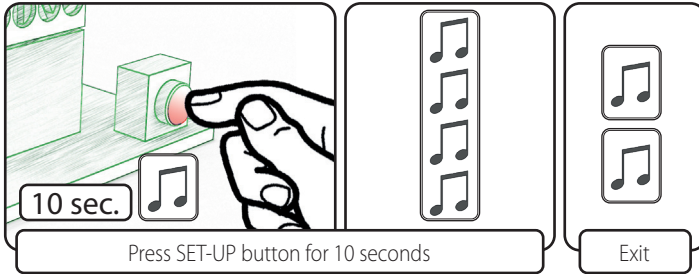

**Attention :** This operation deletes all TAGs, pin codes (keypad escutcheon) or authentication fingerprint escutcheon

NOTE: it does not erase the fingerprints stored in it), and enables the service TAGs.

## 3 - ELECTRICAL WIRING

CONNECTION WITH MOTORIZED LOCKING

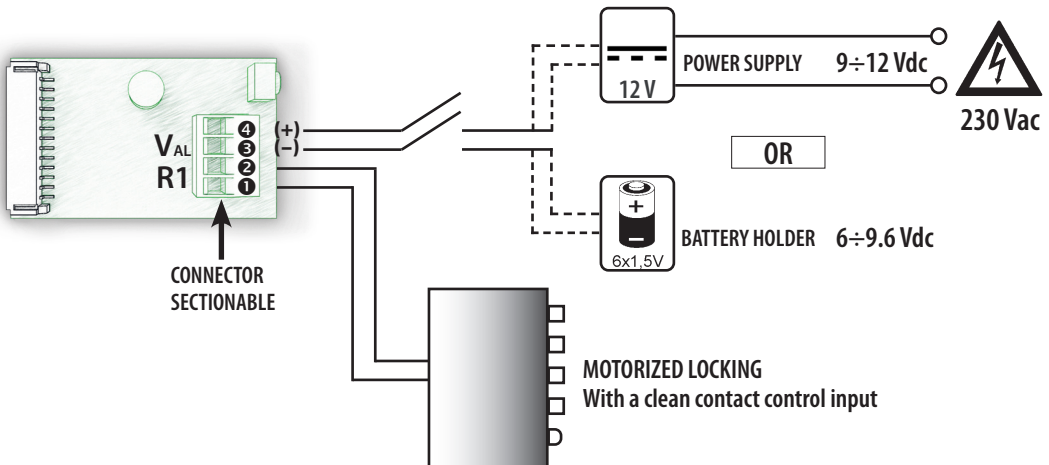



ATTENTION: the relay output can switch loads with a maximum absorption of 500 mA; in the presence of higher absorption it is mandatory to interpose a power relay between the interface and the lock, whose excitation coil does not absorb more than 500 mA. **Failure to comply with this indication can irreversibly damage the interface, with immediate forfeiture of any form of guarantee.**

#### 4 - TECHNICAL DATA

INPUT POWER SUPPLY	VOLTAGE / FREQUENCY	6 ÷ 12 Vdc
	MAX POWER	2 W
	MAX ELECTRICAL ABSORPTION	200 mA
	WORKING TEMPERATURE	Min -10 °C ÷ Max.+55 °C
MECHANICAL	WEIGHT	< 0,1 Kg
	DIMENSIONS	55 x 33 x 21 mm
RELAY OUTPUTS	VOLTAGE MAX	60 Vdc - 500 mA

We recommend using the MOTTURA battery holder cod. 99.703/704 or the mains adaptor cod. 99.683. The contact of the relay provides a fixed-duration impulse of 1 sec. See the wiring diagram supplied before connecting the devices.

## 5 - KEYPAD PROGRAMMING - TAG MANAGEMENT



**WARNING** : If there are no stored TAGs in the control unit (brand new or after a reset), any free TAG Mottura allows you to programming enter! It is therefore necessary immediately to store their own MASTER TAGs, then the service ones, if provided, to ensure maximum security. After this operation only memorized TAGs will be accepted by the control unit.

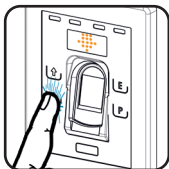
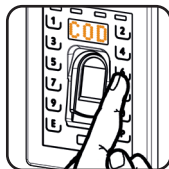

**ONLY** for escutcheons **99775/99776** before each operation, press any key to activate the escutcheon

### 5.1 MEMORIZING MASTER TAG KEYS

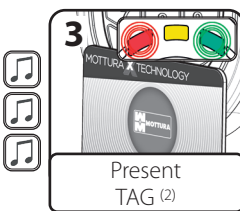
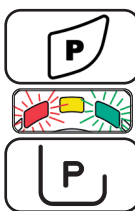
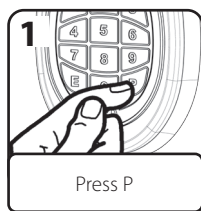

(1) If the lock is new or reset, any free Mottura TAG can be used to enter programming mode!

(2) Becomes MASTER TAG

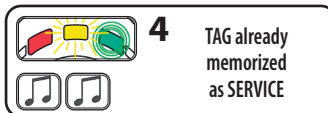

To exit, press "E" or wait 30 sec. (timeout).

### 5.2 MEMORIZING SERVICE TAG KEYS



**WARNING** : if no TAGs are memorized on the control unit (brand new or after a reset), any free Mottura TAG can be used to enter programming mode! You should immediately memorize first your MASTER TAGs, then any service TAGs, to guarantee maximum security.

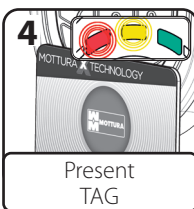
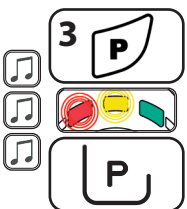
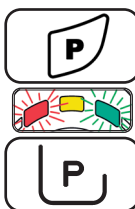
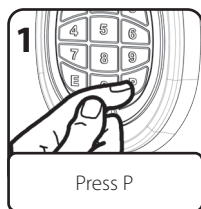

To exit, press "E" or wait 30 sec. (timeout).

### 5.3 DELETING INDIVIDUAL TAG

1 Press P

2 Present MASTER TAG

3 P

4 P

5 Present TAG

6 TAG deleted

6 Unknown TAG

6 ERROR! MASTER TAG

To exit, press "E" or wait 30 sec. (timeout).

**WARNING:** You CANNOT delete the master TAG used to enter programming mode.

### 5.4 DELETING ALL TAG KEYS

1 Press P

2 Present MASTER TAG

3 P

4 P

5 P

6 Type 1-2-3 and press E

7 TAGS being deleted

To exit, press "E" or wait 30 sec. (timeout).

### 5.5 DISABLING/ENABLING SERVICE TAG KEYS

1 Press P

2 Present MASTER TAG

3 P

4 P

5 P

6 P

7-ENABLE To enable, type 1-2-3 and press E

7-DISABILITY To disable, type 3-2-1 and press E

8 To exit press P or E

SERVICE TAGS, if inserted, are disabled

SERVICE TAGS, if inserted, are disabled

## 6 - KEYPAD PROGRAMMING - CODE MANAGEMENT

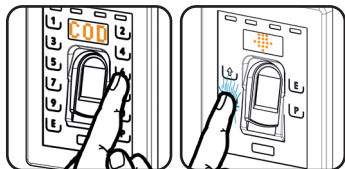

**ONLY** for escutcheons **99775/99776** before each operation, press any key to activate the escutcheon

### 6.1 MEMORIZING PERSONAL ACCESS CODES

**1** Press P

**2** Present MASTER TAG

**3** Press P

**4** Enter the code and press E

**5** CODE stored

**6** CODE already memorized

**WARNING** : Enter a code composed of a minimum of 3 to a maximum of 8 digits

To exit, press "E" or wait 30 sec. (timeout).

### 6.2 DELETING A PERSONAL ACCESS CODE

**1** Press P

**2** Present MASTER TAG

**3** Press P

**4** Press P

**5** Enter the code and press E

**6** CODE deleted

**7** ERROR! Unknown CODE

To exit, press "E" or wait 30 sec. (timeout).

### 6.3 DELETING ALL PERSONAL ACCESS

1 Press P

2 Present MASTER TAG

3 P

4 P

5 P

6 Type 9-8-7 and press E

7 Deleting CODES in progress

To exit, press "E" or wait 30 sec. (timeout).

 **WARNING** : If you push the "P" button, you will get the output from the programming.



Pursuant to article 26 of Italian Legislative Decree no. 49 of 14 March 2014 "Implementation of EU Directive 2012/19 concerning waste electrical and electronic equipment (WEEE)" and article 9 of Italian Legislative Decree no. 188 of 20 November 2008 "Implementation of EC Directive 2006/66 on batteries and accumulators and waste batteries and accumulators" adequate waste sorting for subsequent sending of disposed equipment to recycling, treatment and environmentally compatible disposal contributes to avoiding possible negative effects on the environment and human health and promotes reuse and/or recycling of the materials composing the equipment. Unlawful disposal of the product by the user may result in the application of penalties pursuant to current laws and regulations on the matter. We remind that batteries and power adapters, if present, must be removed before the device is disposed. Batteries and adapters must be collected and separately disposed.

